



Southfield Street, Worcester, WR1 1NH

SHELDON
BOSLEY
KNIGHT

LAND AND
PROPERTY
PROFESSIONALS

Property Description

Situated within walking distance of Worcester City Centre, this beautifully maintained Victorian mid-terraced home is presented to an exceptional standard throughout, offering stylish and spacious accommodation ideal for modern living.

To the front of the property, the first of two reception rooms features built-in storage and an attractive feature fireplace, creating a welcoming and comfortable lounge space. A second reception room, also benefiting from built-in storage, provides an ideal setting for family dining and leads seamlessly into the fully fitted galley-style kitchen.

The contemporary kitchen is finished with a range of stylish grey units and includes an integrated oven and hob, dishwasher, and fridge freezer, along with space and plumbing for additional appliances.

Upstairs, the property offers two generous double bedrooms, including the master bedroom with built-in storage, alongside a spacious and modern family bathroom complete with a shower over the bath.

Double doors from the kitchen open onto a private enclosed rear garden, mainly laid to lawn with a patio area, ideal for outdoor dining or relaxing.

Residents' permit parking is available via Worcester City Council, allowing on-street parking to the front of the property.





Key Features

- Immaculate Period Property
- Two Reception Rooms
- Fully Fitted Kitchen
- Two Double Bedrooms
- Family Bathroom with Shower over Bath
- Enclosed Rear Garden
- EPC Rating: C
- Council Tax Band: B

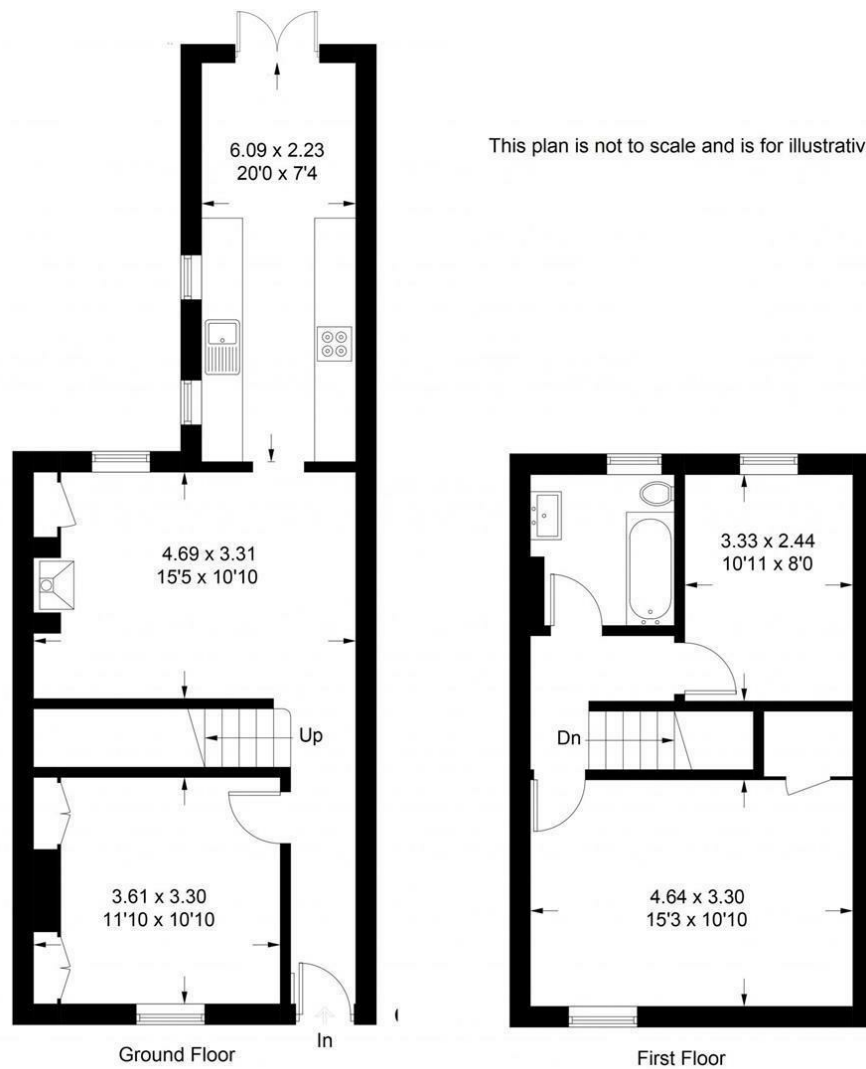

£1,075 PCM